



Oro tiekimo agregatai

Air handling units

Lüftungsgeräte

Приточные агрегаты



- Žemas triukšmo lygis
- Reguliuojamo greičio ventiliatorius (įtampos keitimas)
- Elektrinis šildytuvas
- Lengvai nuimamas dangtis patikrinimui
- Filtrų dėžė su EU3 klasės filtru

Oro tiekimo agregatas skirtas oro tiekimui į patalpas. Jis susideda iš kanalinio ventiliatoriaus, kanalinio oro šildytuvo ir filtrų dėžės. Visi šie elementai sumontuoti izoliuotame korpuse. Izoliacijos storis 50 mm. Korpusas pagamintas iš cinkuotos skardos su lengvai nuimamu dangčiu. Dangtis tvirtinamas keturiais lengvai atsegamais lankstais.



- Niedriges Geräuschniveau
- Ventilator mit Geschwindigkeitsregelung (Spannungsänderung)
- Elektrische Erwärmungseinrichtung
- Leicht abnehmbarer Deckel für Wartung
- Filterkasten mit dem Filter der EU3-Klasse

Das Zuluft-Aggregat ist für Luftlieferung in Räumlichkeiten bestimmt. Es besteht aus einem Kanalventilator, einer Kanal-Luft erwärmungseinrichtung und einem Filterkasten. Alle diese Elemente sind im isolierten Gehäuse montiert. Isolationsdicke 50 mm. Das Gehäuse ist aus verzinktem Blech mit leicht abnehmbarem Deckel hergestellt. Der Deckel wird mit vier leicht aufknöpfbaren Scharnieren befestigt.



- Low noise level
- Fans: ~1f with external rotor motor.
- Adjustable voltage fan control
- Electrical heater
- Easily removable inspection cover
- Filter box with an EU3-class panel filter
- Wall insulation is 50mm

Air supply units for ventilation systems. Not designed for functioning in explosive – inclined areas. The unit is designed for the air supply into premises. It consists of a duct fan, a duct air heater and a filter box. All these elements are installed in an isolated housing. The thickness of the wall insulation is 50 mm. The housing is made of galvanized steel and has an easily removable cover. The cover is attached by four hinges which are easy to unclasp.



- Низкий уровень шума
- Вентилятор с регулировкой скорости (изменение напряжения)
- Электрический нагреватель
- Легко снимаемая крышка для проверки.
- Кассета фильтров с фильтром класса EU3

Агрегат подачи воздуха предназначен для подачи воздуха в помещения. Он состоит из канального вентилятора, канального нагревателя воздуха и кассеты фильтров. Все эти элементы установлены в изолированном корпусе. Толщина изоляции 50 мм. Корпус изготовлен из оцинкованной жести с легко снимаемой крышкой. Крышка крепится легко отстегивающимися шарнирами.

#### Accessories



AP  
p. 200



RSK  
p. 181



AKS  
p. 171



FDI  
p. 164



TJK  
p. 161

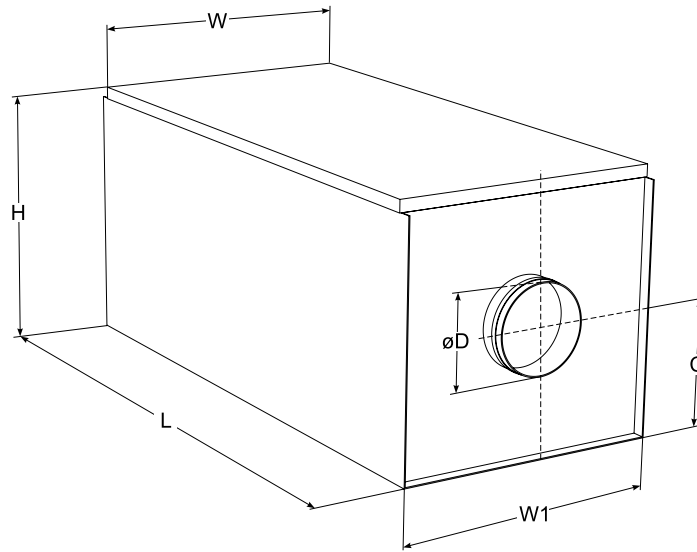

Type	Dimensions [mm]					
	W, mm	W1, mm	C, mm	L, mm	H, mm	øD, mm
OTA 125	490	485	236	1000	490	125
OTA 160	490	485	236	1000	490	160
OTA 200	490	485	236	1000	490	200
OTA 250	550	545	285	1050	585	250
OTA 315	550	545	285	1050	585	315

### Accessories



TGRV  
p. 153



MTY  
p. 156



EKR  
p. 150

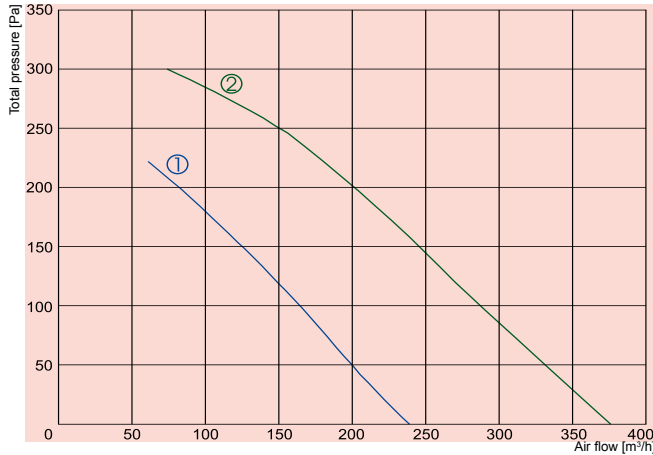

① — OTA 125  
② — OTA 160

		125/1200	160/2000	160/2400	160/5000	160/6000
Heater	-phase/voltage [50Hz/VAC]	~1, 230	~1, 230	~1, 230	~2, 400	~2, 400
	-power consumption [kW]	1,2	2,0	2,4	5,0	6,0
	-min. air speed [m/s]	1,5	1,5	1,5	1,5	1,5
Fan	-phase/voltage [50Hz/VAC]	~1, 230	~1, 230	~1, 230	~1, 230	~1, 230
	-current [A]	0,26	0,41	0,41	0,41	0,41
	-speed [min <sup>-1</sup> ]	2549	2621	2621	2621	2621
	-power consumption [W]	61	93	93	93	93
	-max. airflow [m³/h]	239	376	376	376	376
	-motor protection class	IP-44	IP-44	IP-44	IP-44	IP-44
Terminal box protection class	IP-54	IP-54	IP-54	IP-54	IP-54	
Filter class	EU3	EU3	EU3	EU3	EU3	
Total sound pressure level at 1 m [dBA]	55	61	61	61	61	
Wiring diagram	No. 1	No. 1	No. 1	No. 2	No. 2	

### 125/1200

	Lpa dB(A)	Lwa total dB(A)	Lwa, dB(A)								
			63 Hz	125 Hz	250 Hz	500 Hz	1 kHz	2 kHz	4 kHz	8 kHz	16 kHz
Inlet	57	65	27	38	59	58	60	59	52	43	27
Outlet	55	63	30	39	56	55	58	56	47	38	24
Casing break out	41	49	10	21	41	39	40	39	33	26	10

Measured at 239 m³/h, 0 Pa

### 160/5000

	Lpa dB(A)	Lwa total dB(A)	Lwa, dB(A)								
			63 Hz	125 Hz	250 Hz	500 Hz	1 kHz	2 kHz	4 kHz	8 kHz	16 kHz
Inlet	61	69	31	44	65	59	65	62	56	43	26
Outlet	61	69	32	48	63	64	64	60	55	44	31
Casing break out	44	52	14	27	47	40	45	42	37	26	10

Measured at 197 m³/h, 207 Pa



### ① OTA 200

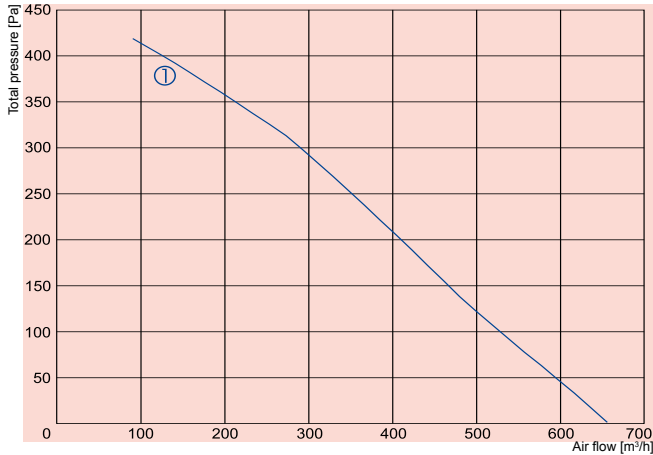

		200/2000	200/2400	200/3000	200/5000	200/6000
Heater	-phase/voltage [50Hz/VAC]	~1, 230	~1, 230	~2, 400	~2, 400	~2, 400
	-power consumption [kW]	2,0	2,4	3,0	5,0	6,0
	-min. air speed [m/s]	1,5	1,5	1,5	1,5	1,5
Fan	-phase/voltage [50Hz/VAC]	~1, 230	~1, 230	~1, 230	~1, 230	~1, 230
	-current [A]	0,71	0,71	0,71	0,71	0,71
	-speed [min <sup>-1</sup> ]	2580	2580	2580	2580	2580
	-power consumption [W]	161	161	161	161	161
	-max. airflow [m³/h]	656	656	656	656	656
	-motor protection class	IP-44	IP-44	IP-44	IP-44	IP-44
Terminal box protection class		IP-54	IP-54	IP-54	IP-54	IP-54
Filter class		EU3	EU3	EU3	EU3	EU3
Total sound pressure level at 1 m [dBA]		61	61	61	61	61
Wiring diagram		No. 1	No. 1	No. 2	No. 2	No. 2

#### 200/6000

	L <sub>pa</sub> dB(A)	L <sub>wa</sub> total dB(A)	L <sub>wa</sub> , dB(A)								
			63 Hz	125 Hz	250 Hz	500 Hz	1 kHz	2 kHz	4 kHz	8 kHz	16 kHz
Inlet	63	71	34	52	64	61	66	66	63	53	38
Outlet	61	69	33	55	64	63	63	60	59	52	40
Casing break out	46	54	17	35	46	42	46	46	44	36	21

Measured at 397 m³/h, 212 Pa

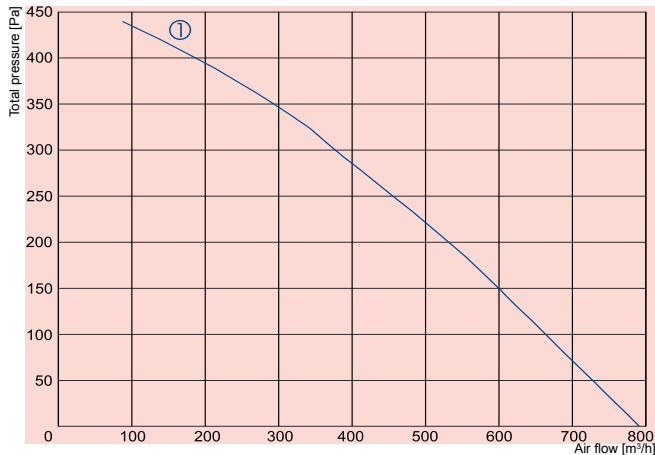

① OTA 250

		250/1200	250/5000	250/6000	250/9000
Heater	-phase/voltage [50Hz/VAC]	~1, 230	~2, 400	~2, 400	~3, 400
	-power consumption [kW]	1,0	5,0	6,0	9,0
	-min. air speed [m/s]	1,5	1,5	1,5	1,5
Fan	-phase/voltage [50Hz/VAC]	~1, 230	~1, 230	~1, 230	~1, 230
	-current [A]	0,70	0,70	0,70	0,70
	-speed [min <sup>-1</sup> ]	2497	2497	2497	2497
	-power consumption [W]	159	159	159	159
	-max. airflow [m³/h]	815	815	815	815
	-motor protection class	IP-44	IP-44	IP-44	IP-44
Terminal box protection class	IP-54	IP-54	IP-54	IP-54	
Filter class	EU3	EU3	EU3	EU3	
Total sound pressure level at 1 m	[dBA]	61	61	61	61
Wiring diagram		No. 1	No. 2	No. 2	No. 3

### 250/9000

	L <sub>pa</sub> dB(A)	L <sub>wa</sub> total dB(A)	L <sub>wa</sub> , dB(A)								
			63 Hz	125 Hz	250 Hz	500 Hz	1 kHz	2 kHz	4 kHz	8 kHz	16 kHz
Inlet	63	71	37	53	64	61	65	66	63	54	38
Outlet	61	69	33	54	65	62	62	61	60	53	40
Casing break out	46	54	20	36	46	42	45	46	44	37	21

Measured at 513 m³/h, 228 Pa

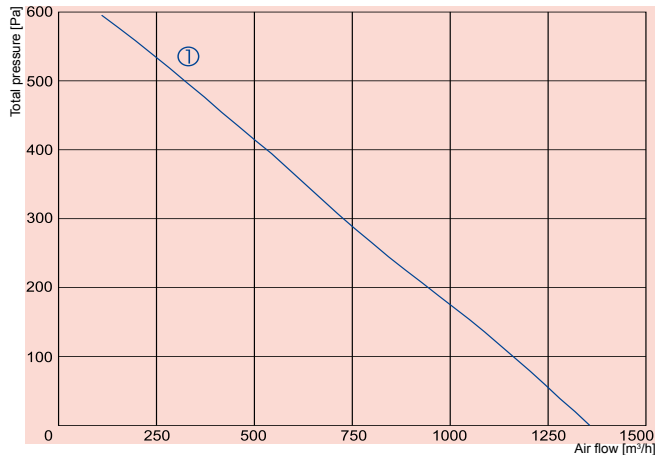

① OTA 315

		315/5000	315/6000	315/9000
Heater	-phase/voltage [50Hz/VAC]	~2, 400	~2, 400	~3, 400
	-power consumption [kW]	5,0	6,0	9,0
	-min. air speed [m/s]	1,5	1,5	1,5
Fan	-phase/voltage [50Hz/VAC]	~1, 230	~1, 230	~1, 230
	-current [A]	1,27	1,27	1,27
	-speed [min <sup>-1</sup> ]	2316	2316	2316
	-power consumption [W]	293	293	293
	-max. airflow [m³/h]	1356	1356	1356
	-motor protection class	IP-44	IP-44	IP-44
	Terminal box protection class	IP-54	IP-54	IP-54
	Filter class	EU3	EU3	EU3
	Total sound pressure level at 1 m [dBA]	62	62	62
	Wiring diagram	No. 2	No. 2	No. 3

### 315/9000

	L <sub>pa</sub> dB(A)	L <sub>wa</sub> total dB(A)	L <sub>wa</sub> , dB(A)								
			63 Hz	125 Hz	250 Hz	500 Hz	1 kHz	2 kHz	4 kHz	8 kHz	16 kHz
Inlet	65	73	37	59	64	62	68	69	64	57	46
Outlet	62	70	34	59	63	64	62	63	61	56	47
Casing break out	48	56	20	42	46	43	48	49	45	40	29

Measured at 828 m³/h, 249 Pa

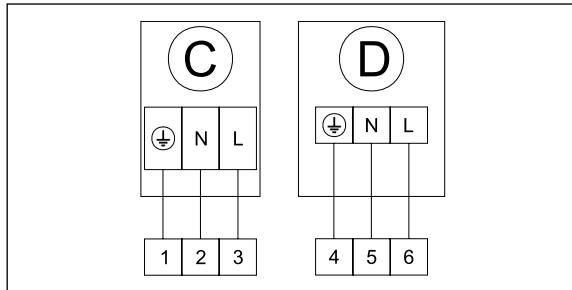

**Wiring diagram No. 1**

**C** - Circular fan  
**D** - Electrical heater

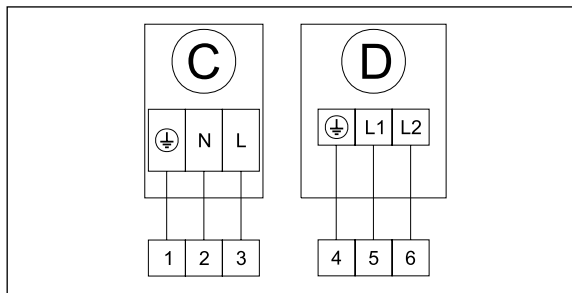

**Wiring diagram No. 2**

**C** - Circular fan  
**D** - Electrical heater

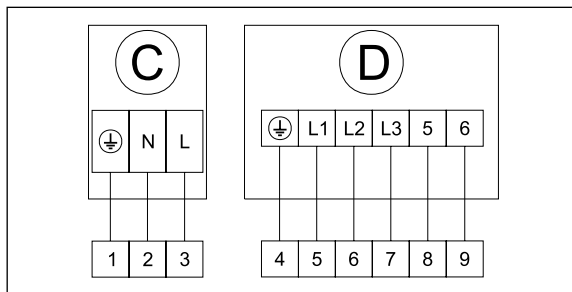

**Wiring diagram No. 3**

**C** - Circular fan  
**D** - Electrical heater